



Installation Guide for
Large Flat Ultimate Fixed Frame Screen (100mm Frame)



Model: PP-Lxxx,PP-Gxxx,PH-Lxxx(10),PH-Gxxx(10)

Thank you for purchasing the projection screen.
Before use, please read instructions carefully.
After installation, store instructions for future reference.

Technical Assistance

If you need help with installing this screen please visit
www.sapphireav.com



Diagram

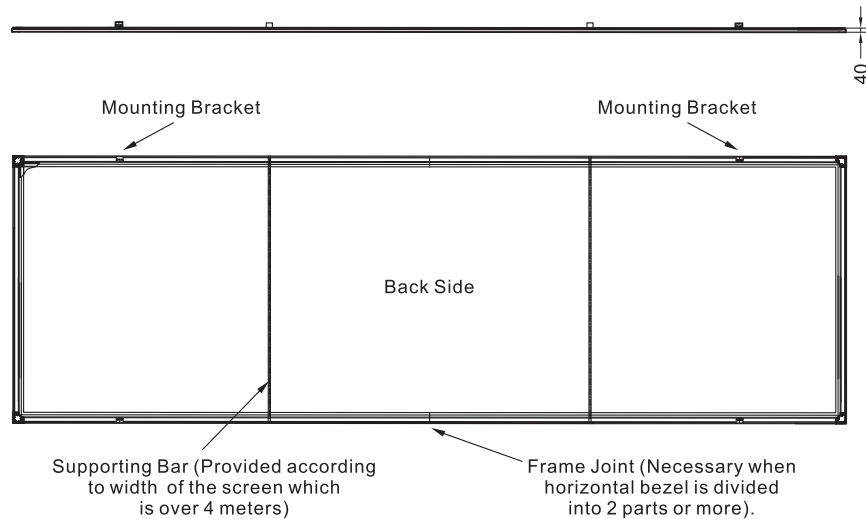
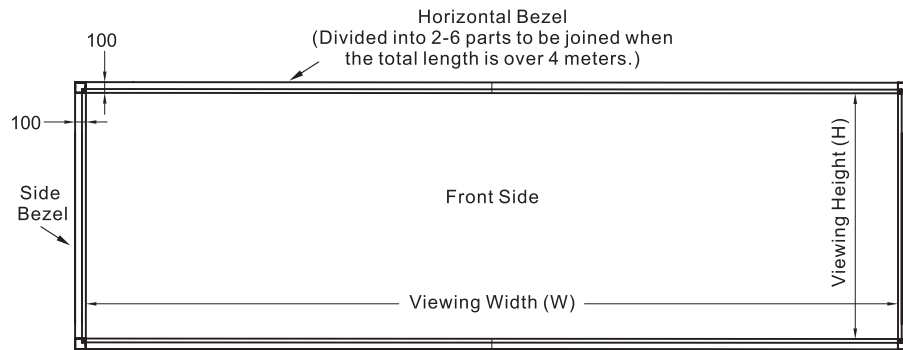

Figure 1
Diagram For Flat Screen

Warnings

1. When installing, make sure it is facing forward. The back of the screen will be labeled with a sticker.
2. The frame is made with lightweight aluminum. Please handle with care.
3. If it is not in use for a long period of time, cover the screen to shut out dust and dirt.
4. It is strongly recommended not to use any detergents, abrasives or solvents as many of these chemical solutions can fade the screen.
5. Use a cotton cloth to carefully wipe off the dust on the frame to prevent any damages.
6. Do not write or draw on the surface.
7. To prevent unnecessary damage, the operating and maintenance of the screen should be done by adults.



Notice

Ignoring the safety warnings may lead to injuries and/or damaging the product.



Force

Fixtures should be installed in a secure place to avoid accidents or the screen falling.



Prohibition of disintegration

Please contact your local dealer for repairs or maintenance. Please contact our company if you have any further questions. Avoid taking apart the fixtures yourself. Loose parts may cause the screen to fall.

Do not take apart and replace with unknown parts. If there are any problems, please contact your local dealer. Product specifications are subject to change.

Accessories

- Horizontal Bezel (2pcs or more depending on the total length if it is over 4 meters).



- Side Bezel (2pcs)



- Supporting Bars (2pcs or more depending on the total length of the frame).



- Screen (1pc)



- $\Phi 4.5\text{mm}$ Horizontal Tension Bar (2pc)



- $\Phi 4.5\text{mm}$ Sidel Tension Bar (2pc)



- Support Bar Screws, Support Bar Screw Caps, Mounting Bracket Screws, Square Screw Caps



- Screw for Connector (4pcs or more)



- Mounting Brackets (Provided according to model and length of the screen).



Large Flat Fixed Frame Screen



Curved Fixed Frame Screen



Screw Anchor Sets



Screws, Screw Cushions, Screw Caps for connection parts



Snap Lug



Springs/Hook(2pc)



Open-ended Spanner

- Instruction Book (1pc)
- Warranty Card (1pc)

- QC Pass Card (1pc)

Installation

9. Measure the installation distance and punch the holes on the wall with setscrew (not included).
Fix the mounting brackets on the wall and make sure it is firm and tight before hanging screen onto the brackets. Fix the screen with mounting brackets with screws

Force Notice: Please make sure that the maximum suffer weight of the wall is twice as the weight of the screen to ensure safety.

10. The mounting brackets for Flat Screen are in the same size (see figure 18), which are proved 4 to 12pcs (according to the screen size). Please refer to figure 19- figure 21 for installation instructions.

Note: The nuts should be inserted into the horizontal bezel according to the number of mounting brackets before joining the horizontal and side bezels together (please see figure 5).

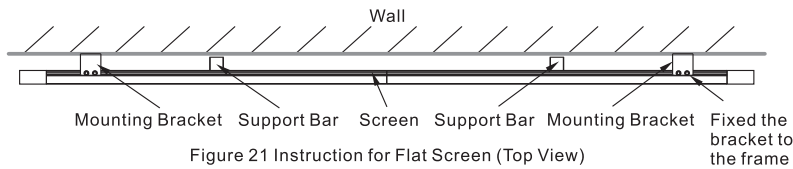
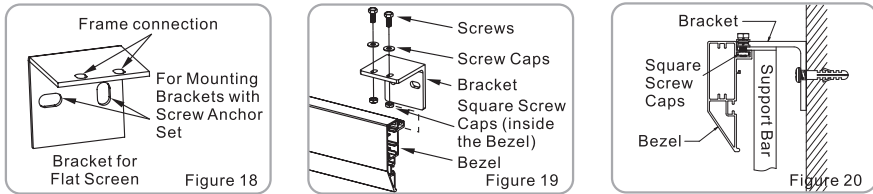

11. For installation of the Curved Fixed Frame, the short side of mounting bracket should be facing down. Please refer to figure 23-figure 26 for how to mount the frame onto brackets.
If the screen is in long size to be mounted in the curved wall, the mounting brackets provided should be the same as those of Flat Screen (see figure 26).
Please refer to figure 25-figure 26 for mounting the screen onto the flat wall and curved wall.

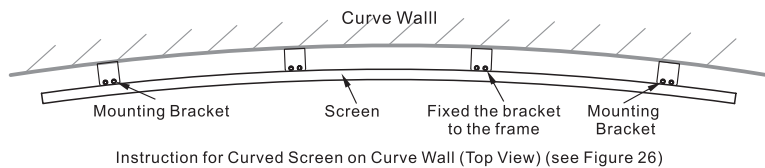
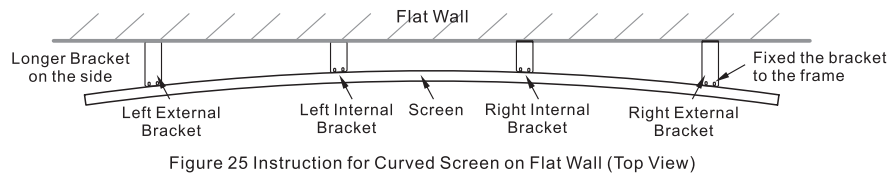
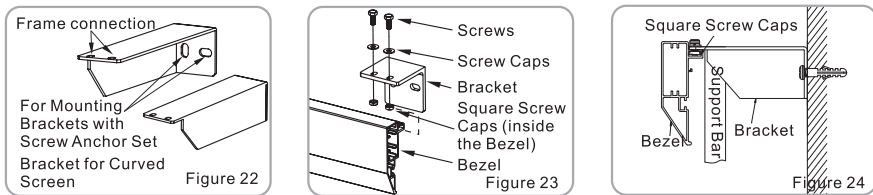

Diagram

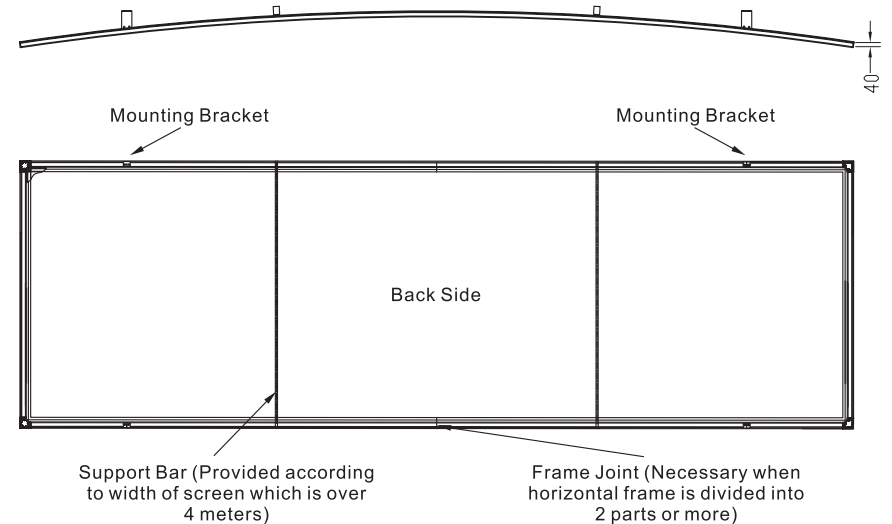
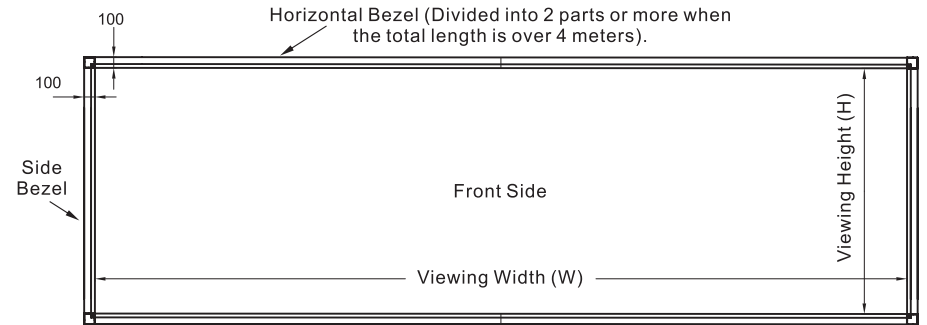

Installation

Take out all the parts from the package and follow the accessories guideline to ensure you have all parts then install the screen as.

1. Create a clean-flat work area for assembly using the attached Protection Pad. Align Horizontal Bezel and Side Bezel to be a Rectangle. (see Figure 3)

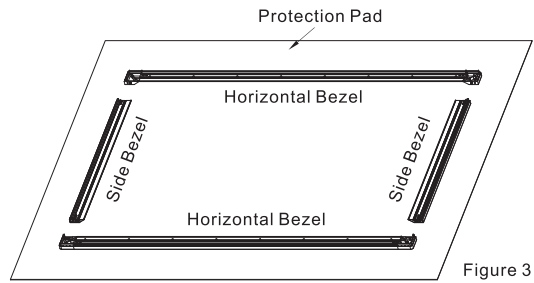

Figure 3

2. Insert the Snap Lugs into the recess slots (as shown in figure 4); and insert the M6 Square Screw Caps into another recess slot (as shown in figure 5); (Please skip this step if this is a Spring-Hook Screen).

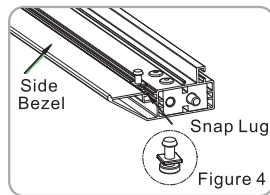

Figure 4

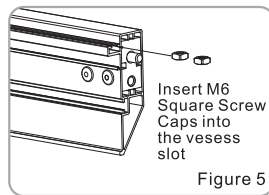

Figure 5

3. Align the corner connector screws to the corner connector screw holes (see figure 6). Fasten hexagonal screws according to the priority as shown in the figure 7.

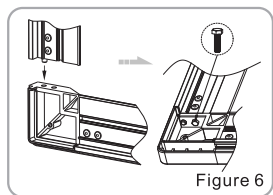

Figure 6

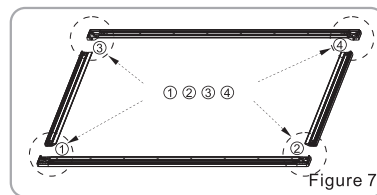

Figure 7

4. For long frame which are divided into parts for easy transportation (normally divided into 2-6 parts when the total length is over 4 meters, see figure 8).

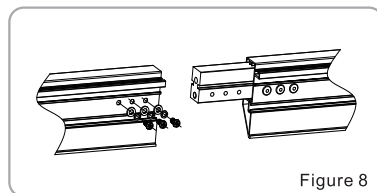

Figure 8

Installation

5. Unfold screen fabric and insert 4 tensioning bars separately into 4 different fabric grooves, be careful not to poke the fabric. (Note: better to do this step with two people. Figure 9)

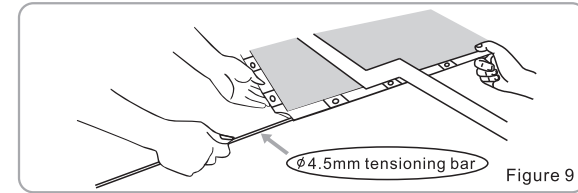

Figure 9

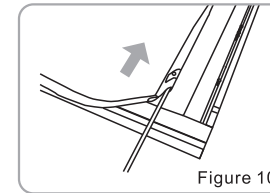

Figure 10

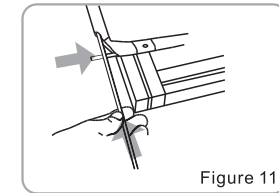

Figure 11

6. Snap Lugs Frame installation: Adjust the distance between Snap Lugs to fit the holes on the edge of fabrics and then clap the fabric on the Snap Lugs one by one. It is recommended to operate the long side first (see figure 12, 13). Spring-Hook Screen installation: Hitch the bigger opening side on the Tensioning Bar, and started with the other end on the corner of the frame, and hitch the rest in sequence. (see figure 14-16)

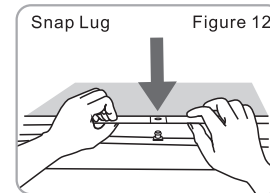

Figure 12

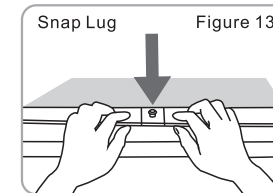

Figure 13

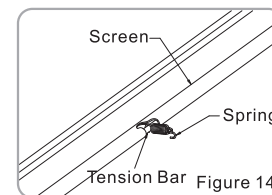

Figure 14

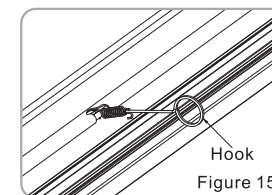
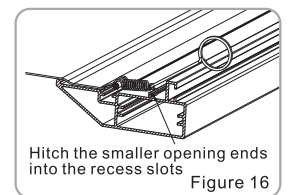

Figure 15



Hitch the smaller opening ends into the recess slots
Figure 16

7. Make a necessary adjustment to keep the fabric flat and smoothly.
8. Please install the Support Bar onto the frame and fix it with screws (It is provided when the width of the frame is over 4 meters). (see figure 17)

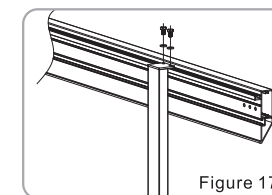

Figure 17