

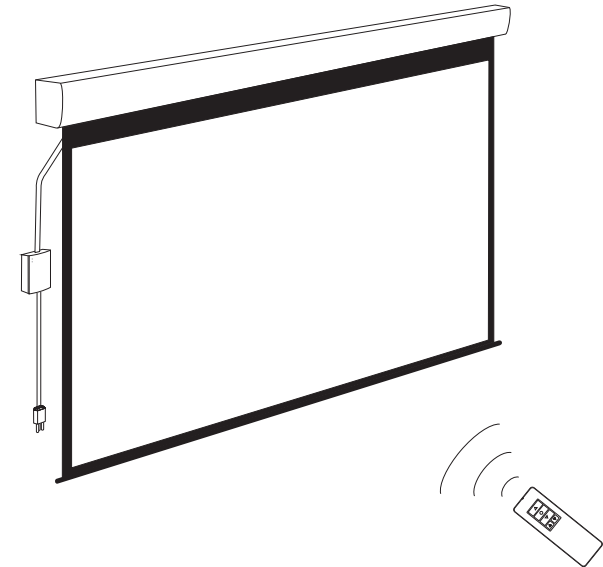

Instruction Manual for 3.0m and above Mayfair Range of electric screens



Thank you for purchasing a sapphire projection screen.
Before use, please read instructions carefully. After installation, store instructions for future reference.

Technical Assistance

If you need help with installing this screen please visit
www.sapphireav.com



Description

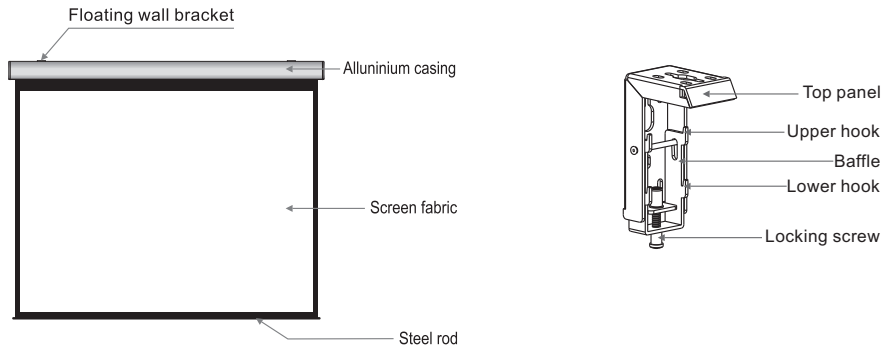

Accessories

- Floating wall bracket(2pcs)
- $\phi 5 \times 40$ mm Tapping screw & cap (8 sets)
- Hanging bracket (2pcs)

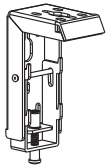

- M5x10 Screw (6pcs)



- Allen key (1pc)



- Instruction manual (1pc)

Warnings

- Always ensure that there is solid wood, concrete, metal or a solid wall to fix to. Never use just plasterboard and ensure that you test the fixings carefully before hanging the screen.
- When you offer up the screen ensure that you have it locked into the bracket securely at both ends.
IF YOU HAVE ANY CONCERNS ABOUT THE STABILITY OF THE BRACKET FIXINGS DO NOT HANG THE SCREEN TAKE PROFESSIONAL ADVICE FROM A BUILDING SURVEYOR OR OTHER PROFESSIONAL INSTALLER.
- While installing electrical motors, please hire professionals or your local dealer to ensure safety.
- Please read the following as any damage to the screen surface will affect the quality of the picture:
 - 1.Avoid contact or touching the screen surface as it may cause scratches or tears.
 - 2.Do not write or draw on the surface
 - 3.Clean the screen with a soft cloth and lukewarm water . Do not use any detergent or cleaning products.
- Roll up the screen after every use. Ensure that the screen is level when installing ;do not pull on the sides or fold the screen.
- To prevent damage , the operating and maintenance of the screen should be done by adults.



Ignoring the safety warnings may lead to injuries and/or damaging the product.



Fixtures should be installed in a secure manner to avoid accidents or the screen falling.



Do not connect any electrical attachments or remote controls.



Roll up the screen after every use. Leaving it hanging for a long period of time may cause the fabric to stretch.



Please contact your local dealer for repairs or maintenance. Avoid taking apart the screen or the warrants will be void.



Refrain from hanging anything on the screen as it may cause the screen to fall.

Product specifications are subject to change.

Motorized Screen Power Specifications

Voltage	Frequency	Watts	Application
230V/120V/100V	50Hz/60Hz	160W/90W	Applies 150" ~200" motorized screens

Instructions

To avoid overheating the motor, do not continually retract and lower the screen for over 4 minutes at a time. If the motor overheats, it will need a cool down time of 2 minutes. The motor does not need any lubricants. The drop and retract limit of the screen is factory preset to an optimal configuration. Please ask your local dealer or professional to adjust settings to avoid damaging the motor.

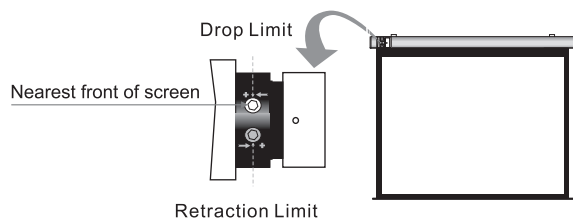

adjusting the bottom drop of the fabric

(+ ←) Turn anticlockwise for the screen to come down further.

Turn clockwise to reduce the drop and therefore the amount of black border at the top of the screen.

adjusting the top stops on the screen fabric.

(→ +) Turn the allen key anticlockwise to make the screen stop earlier when going into the case. If you turn the key clockwise the screen will retract further into the case. **MAKE SURE YOU TURN THIS CAREFULLY AS WE WILL NOT BE RESPONSIBLE FOR DAMAGE SHOULD THE MOTOR OR FABRIC SHOULD IT TRY TO PULL THE FABRIC TOO FAR INTO THE CASE.**

Each turn of the key will only make a small difference to the drop of the screen approx 10cm.

Installation

Take out all the parts from the packaging and follow the accessagires guideline to ensure you have all parts.

There are three installation measures for this product, namely wall mounting, ceiling mounting and ceiling hang. The installed distance can be changeable up to your needs via adjusting the slipper block, while the ideal position is the mounting bracket is at its nearest point to the endcap, which can reduce unnecessary vibration or noise.

Floating wall bracket installation

1. Choose screws for mounting according to wall material. (Tips: Wood screws for wood wall, and Tapping screws for concrete wall.)
2. Mount the brackets onto the wall, assuring they are at the horizontal level. (Tips: draw an erasable level line when mounting the brackets) (Figure 1) Here below are the details:

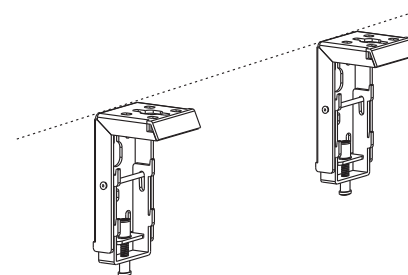

Figure 1

Installation Steps

- a) Wood wall and ceiling installation: Drill in the $\phi 5 \times 40$ screws through the appropriate holes in the bracket (Figure 2-3).
- b) Drywall and ceiling and installation: Install the anchors and drill in the 5×40 screws into the appropriate bracket holes. (Figure 4-5).

Wood wall installation

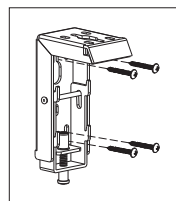

Figure 2

Wood ceiling installation

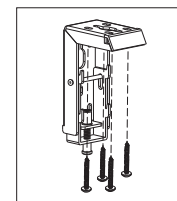

Figure 3

Concrete wall installation

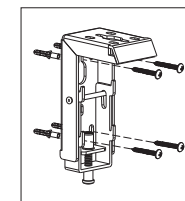

Figure 4

Concrete ceiling installation

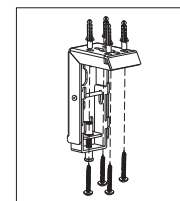
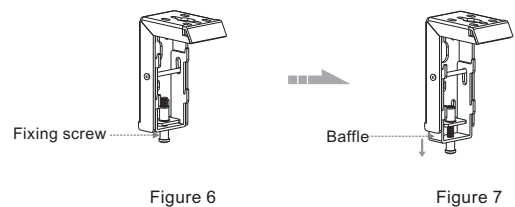
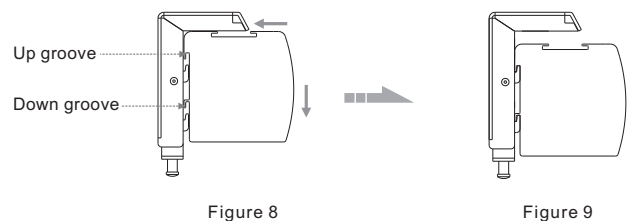

Figure 5

3. Loosen the locking screw to lower the bracket clamp all the way down. (Figure 6-7)



4. Mount the projection screen by sliding the casing grooves over the bracket hooks. (Figure 8-9)



5. Tighten the locking screw to clamp the screen securely in place.) Figure 10-11 (

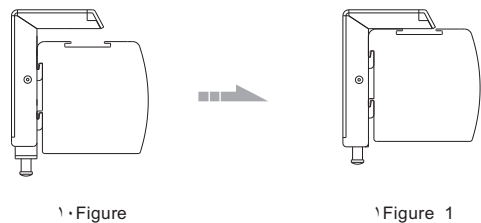

Ceiling hang installation

Each end of the screen casing needs to be supported by a hook (not provided). Ensure that the suspension system (cable and/or hook) can support the weight of the screen.

1. To drill two same holes with an electric drill horizontally with wall, then fasten hangers (unprovided) onto the ceiling. (Figure 12)

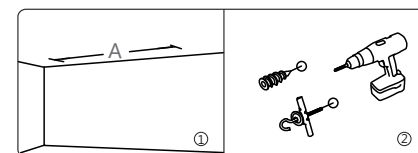

Figure 12

2. Use three M5x10mm screws to fasten the hanging brackets, to the wall and ceiling brackets as shown. (Figure 13-14)

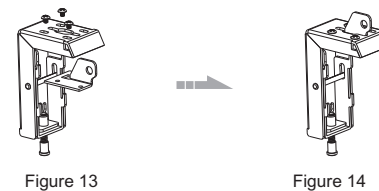

Figure 13

Figure 14

3. Attach the wall and ceiling brackets to the casing as shown in figures 15 and 16.

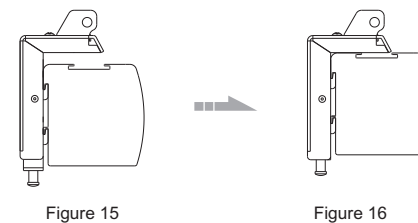

Figure 15

Figure 16

4. Place hooks through the hanging brackets to suspend the projection screen as shown. See figure 17.

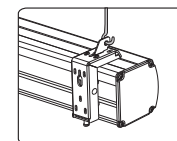

Figure 17